

Tree Preservation Order

Town and Country Planning Act 1990

The SOUTH KESTEVEN DISTRICT COUNCIL (LAND AT HIGHFIELD HOUSE, COLD HARBOUR LANE, GRANTHAM) TREE PRESERVATION ORDER 2021

The South Kesteven District Council, in exercise of the powers conferred on them by section 198 of the Town and Country Planning Act 1990 make the following Order—

Citation

1. This Order may be cited as SOUTH KESTEVEN DISTRICT COUNCIL (LAND AT HIGHFIELD HOUSE, COLD HARBOUR LANE, GRANTHAM) TREE PRESERVATION ORDER 2021

Interpretation

2.— (1) In this Order “the authority” means the South Kesteven District Council

(2) In this Order any reference to a numbered section is a reference to the section so numbered in the Town and Country Planning Act 1990 and any reference to a numbered regulation is a reference to the regulation so numbered in the Town and Country Planning (Tree Preservation)(England) Regulations 2012.

Effect

3.— (1) Subject to article 4, this Order takes effect provisionally on the date on which it is made.

(2) Without prejudice to subsection (7) of section 198 (power to make tree preservation orders) or subsection (1) of section 200 (tree preservation orders: Forestry Commissioners) and, subject to the exceptions in regulation 14, no person shall—

(a) cut down, top, lop, uproot, wilfully damage, or wilfully destroy; or

(b) cause or permit the cutting down, topping, lopping, uprooting, wilful damage or wilful destruction of,

any tree specified in the Schedule to this Order except with the written consent of the authority in accordance with regulations 16 and 17, or of the Secretary of State in accordance with regulation 23, and, where such consent is given subject to conditions, in accordance with those conditions.

Application to trees to be planted pursuant to a condition

4. In relation to any tree identified in the first column of the Schedule by the letter “C”, being a tree to be planted pursuant to a condition imposed under paragraph (a) of section 197 (planning permission to include appropriate provision for preservation and planting of trees), this Order takes effect as from the time when the tree is planted.

Dated this **2nd June 2021**

The Common Seal of South Kesteven District Council
was affixed to this Order in the presence of—

[REDACTED]

Andrew Cotton

Director of Housing & Property.



HIS ORDER WAS CONFIRMED BY THE SOUTH KESTEVEN DISTRICT COUNCIL
ON THE DATE 4 AUGUST 2021

[REDACTED]
PRINCIPAL PLANNING OFFICER

SCHEDULE
Specification of trees

Trees specified individually (encircled in black on the map)

Reference on map	Description	Situation
T1	Copper Beech	South West Side Of Highfield House, Cold Harbour Lane, Grantham
T2	Copper Beech	South West Side Of Highfield House, Cold Harbour Lane, Grantham
T3	Copper Beech	South West Side Of Highfield House, Cold Harbour Lane, Grantham

Groups of trees (within a broken black line on the map)

Reference on map	Description	Situation
G1	14 x Lime Trees	To The West Of Highfield House, Cold Harbour Lane, Grantham

Trees specified by reference to an area (within a dotted black line on the map)

Reference on map	Description	Situation
NONE		

Trees specified individually (encircled in green on the map)

Reference on map	Description	Situation
NONE		

LAND AT HIGHFIELD HOUSE, COLD HARBOUR LANE, GRANTHAM TREE PRESERVATION ORDER 2021

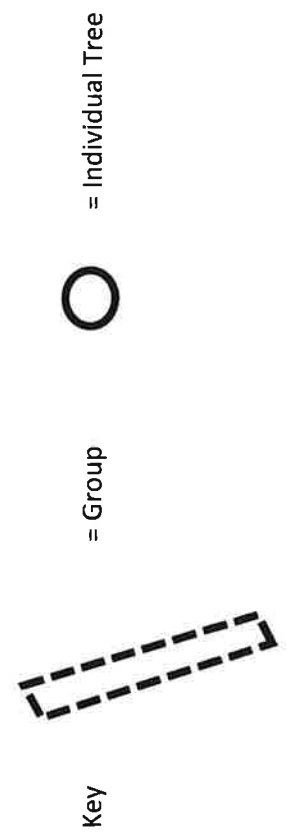
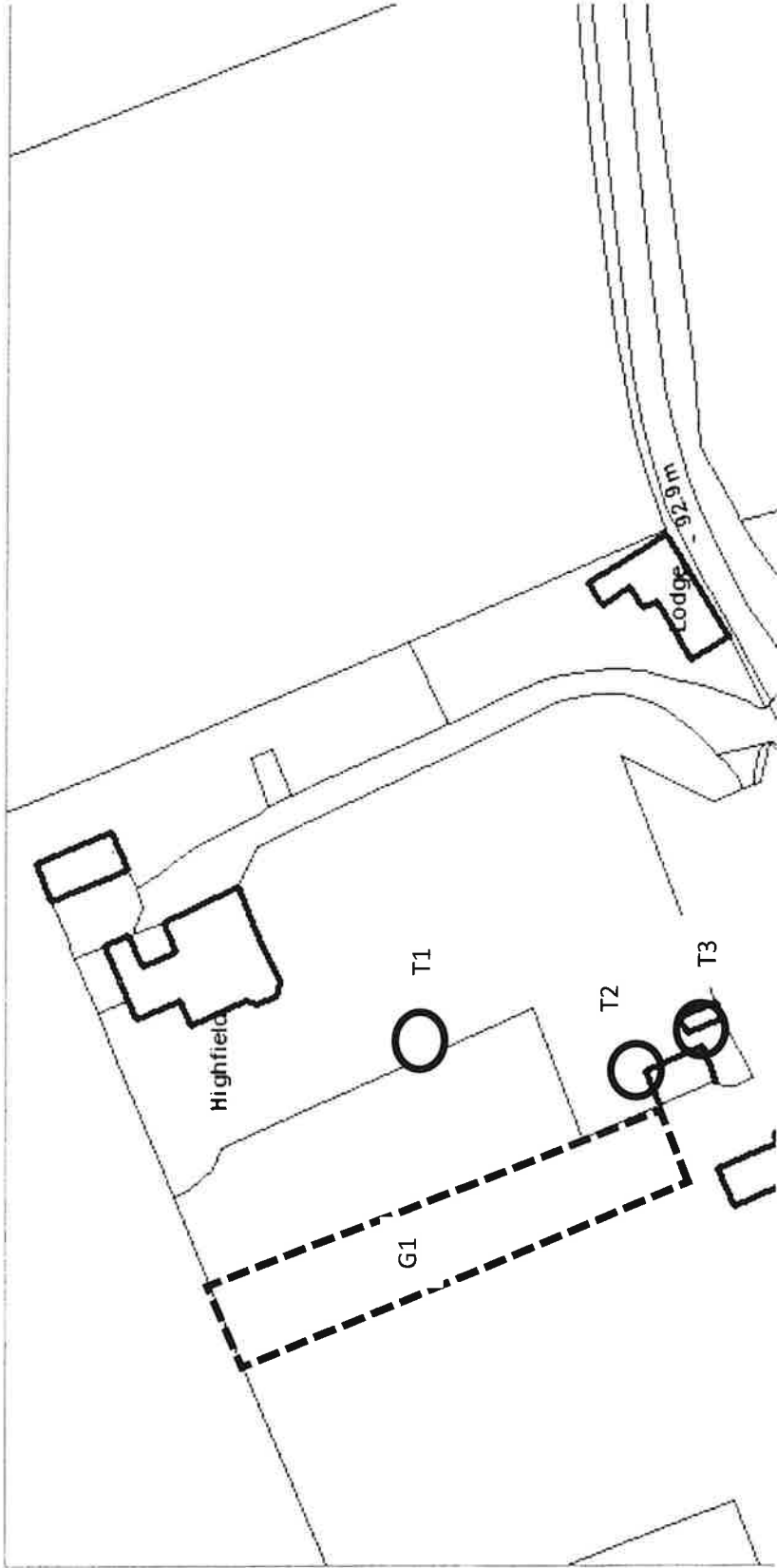



**TOWN AND COUNTRY PLANNING ACT 1990
TOWN AND COUNTRY PLANNING
(TREE PRESERVATION) (ENGLAND) REGULATIONS 2012**

Tree Preservation Order:

**SOUTH KESTEVEN DISTRICT COUNCIL (LAND AT HIGHFIELD
HOUSE, COLD HARBOUR LANE, GRANTHAM) TREE
PRESERVATION ORDER 2021**

On 2ND June 2021 we made the above tree preservation order, and sent you a copy.

We have considered whether or not the order should be confirmed (or in other words, made permanent). On the 4th August 2021 the Council decided:

To confirm the order

We have made the order as the trees, when viewed collectively, add visual merit to the amenity and are cohesive arboricultural features in the broad and immediate landscape now and in the long term. They are easily seen from a distance and nearby. This order follows on from previous order T18/0005 which was not confirmed at the time. For more information about our decision, please contact Julie Carroll 01476 406080.

If you wish to cut down, top or lop any of the trees described in the first schedule of the order and shown on the map enclosed with the order permission must be obtained from South Kesteven District Council before any work is carried out on the trees. If you require help or information please contact the Council's Development Management Services, South Kesteven District Council, Council Offices, St Peter's Hill, Grantham, NG31 6PZ.

If you disagree with our decision you can challenge it by applying to the High Court under section 284 (validity of development plans and certain orders, decisions and directions) of the Town and Country Planning Act 1990. You can apply to the High Court if you believe:

- (1) the order is not within the powers of the Town and Country Planning Act 1990; or
- (2) the requirements of Town and Country Planning (Tree Preservation) (England) Regulations 2012 have not been met.

You must apply to the High Court within six weeks from the date of our decision.

Signed

Dated 4th August 2021

Principal Planning Officer